

MODULAR FLAT GATE VALVE TYPE SMFS-GM

SHUT-OFF - COMPONENT FOR SILO AND CONTAINER SYSTEMS WITH OPTIMAL SEALING – MOTOR DRIVEN



The **modular gate valve TYPE SMFS-GM** is attached to silo and vessel discharges and assures the optimal sealing of stored dusty and granular bulk goods up to 8 mm in size. The motor driven flat gate can also be used as a proportional slide gate. This modular gate allows the installation of various drive configurations - manual, pneumatic, or electric motor driven - on the same base frame.

Areas of Application

- Grain size up to 8 mm
- High quality gate plate sealing; packing box easily adjustable and exchangeable
- Slide plate made of stainless steel 1.4301, ground
- Steel guide on the slide gates upper side
- Ball track rollers sealed on both sides
- Large, easily removable protective covers
- Low overall height
- Ex-protected
- Special paintwork on request
- Special sizes on request
- High-temperature version
- position indicator
- Other materials: e.g. stainless steel 1.4301 / 1.4571

Details / Explanation

- Rust removal: SA 2,5
- Primer: 2K; 40µm
- Top coat: 2K; RAL 9006; 40µm

Finish

Spare parts drawing

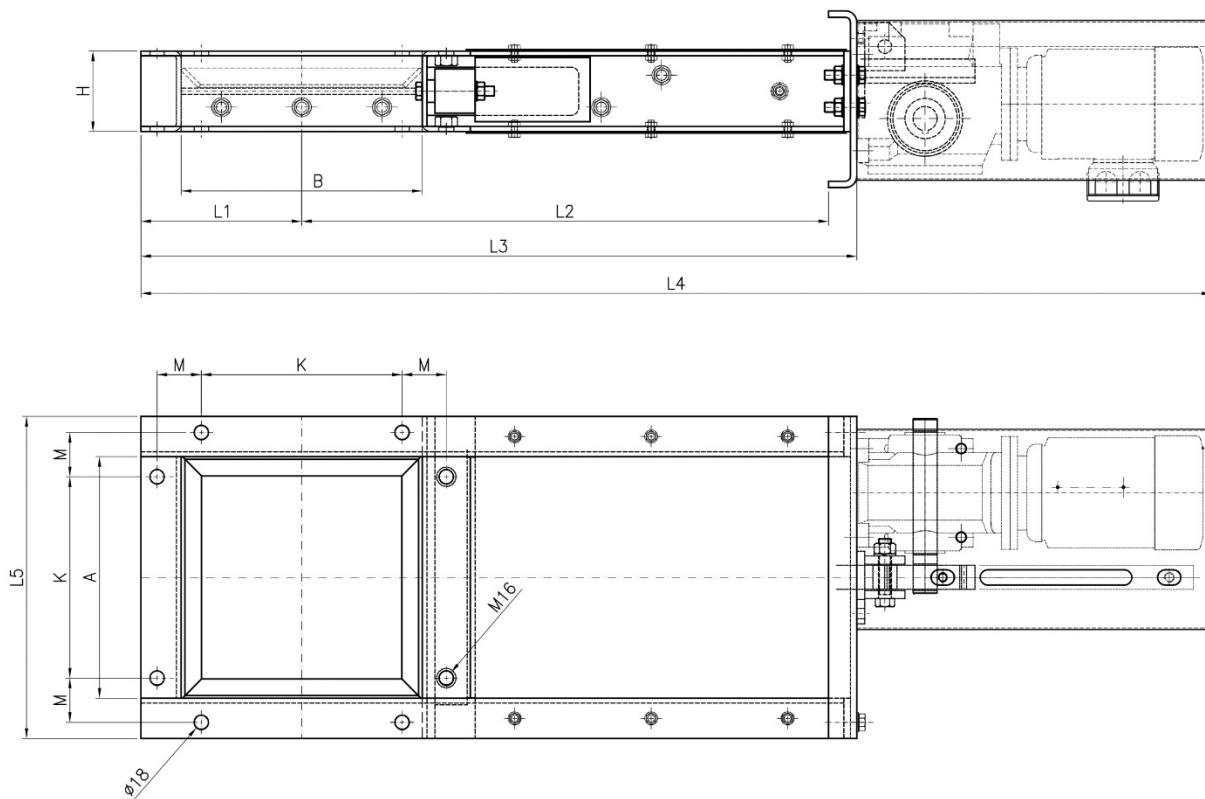

Dimensions Flat Gate Type SMFS - GM

AxB [mm]	Article No.	Weight [kg]	K [mm]	M [mm]	L1 [mm]	L2 [mm]	L3 [mm]	L4 [mm]	L5 [mm]	H [mm]	Proximity switches	P [kW]
200x200	712 10 280	62	150	55	150	500	690	1140	300	100	24V DC/ 230V AC or mechanical	0,83 230/400V (3,4/2,0A) 50 Hz
250x250	712 10 299	67	200	55	175	575	790	1240	350	100		
300x300	712 10 270	75	250	55	200	650	890	1340	400	100		
350x350	712 10 300	78	280	65	225	726	990	1440	450	100		
400x400	712 10 274	80	300	80	250	800	1090	1635	500	100		
450x450	712 10 303	92	330	90	275	881	1190	1685	550	100		
500x500	712 10 277	105	350	105	300	950	1290	1933	600	100		
600x600	712 10 307	133	380	120	325	1025	1390	2030	700	120		

Subject to technical changes

Special solutions gate valve type SMFS - GM
Special sizes on request

Notice



Accessories / Spare parts

	Article No.	
Geared motor 0,83 kW/400V/AC	712 10 256	
Geared motor 1,1 kW/400V/AC	712 10 256-01	
Limit switches 24V/DC IG5533	881 10 270	
Limit switches 230V/AC IG0006	881 10 222	
Limit switch mechanical	751 10 080	
Ball bearing - standard	712 10 143	

	Type	Article No.	
Stuffing box packing / Gasket Set for 1 slider (3 pieces)	SMFS 200 x 200	712 10 285	
	SMFS 250 x 250	712 10 286	
	SMFS 300 x 300	712 10 287	
	SMFS 350 x 350	712 10 288	
	SMFS 400 x 400	712 10 289	
	SMFS 450 x 450	712 10 290	
	SMFS 500 x 500	712 10 291	

	Type	Article No.	
Gasket block	SMFS 200 x 200	712 10 278 102	
	SMFS 250 x 250	712 10 294 102	
	SMFS 300 x 300	712 10 268 102	
	SMFS 350 x 350	712 10 282 102	
	SMFS 400 x 400	712 10 274 102	
	SMFS 450 x 450	712 10 296 102	
	SMFS 500 x 500	712 10 275 102	

	Type	Article No.	
Slide plate	SMFS 200 x 200	712 10 278 101	
	SMFS 250 x 250	712 10 294 101	
	SMFS 300 x 300	712 10 268 101	
	SMFS 350 x 350	712 10 282 101	
	SMFS 400 x 400	712 10 274 101	
	SMFS 450 x 450	712 10 296 101	
	SMFS 500 x 500	712 10 275 101	

Spare parts old version

	Type	Article No.	
Seal kit 2 x round felt + X x half round felt	flat slide 200 x 200	712 10 142	
	flat slide 250 x 250	712 10 064	
	flat slide 300 x 300	712 10 003	
	flat slide 400 x 400	712 10 058	
	flat slide 500 x 500	712 10 189	

Pressing device	712 10 251	
-----------------	------------	---